

WIRE TO PCB TYPE TERMINAL BLOCK — ETB58 SERIES



BARRIER TYPE

PITCH=7.62mm

■ FEATURES

- Can be supplied in any number of positions
- Special wire protector design to ensure reliable wire clamping
- UL 94V-0 grade fire retardant engineering plastic used for the housing
- Be capable of clamping a wide range of wire diameters
- Wide choice of pitch & terminal

■ SPECIFICATIONS

- Pitch 7.62mm (0.3 inch)
- Wire range 16~22 AWG
- Rating 10 Amp, 300 VAC
- Housing material Thermoplastic (UL 94V-0) Black
- Terminals Tin plated over Brass
- Screws Nickel plated over Steel
- Dielectric strength 2000 VAC (Min.)
- Insulation resistance 1000 MΩ, 500 VDC



■ PART NUMBERING SYSTEM

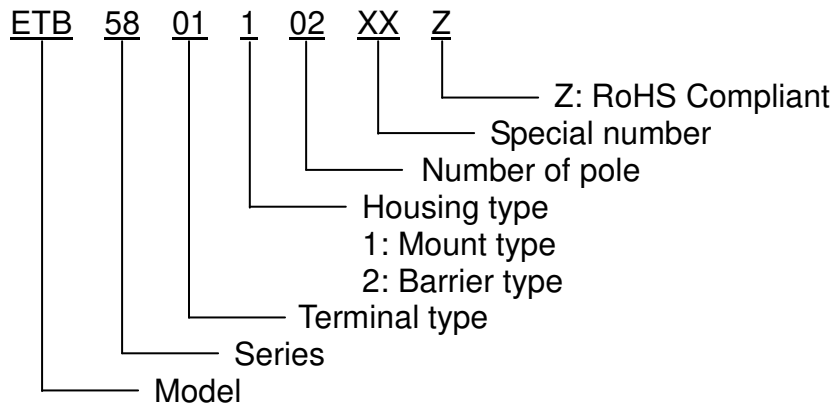

WIRE TO PCB TYPE TERMINAL BLOCK — ETB58 SERIES



■ DRAWING (BARRIER TYPE)

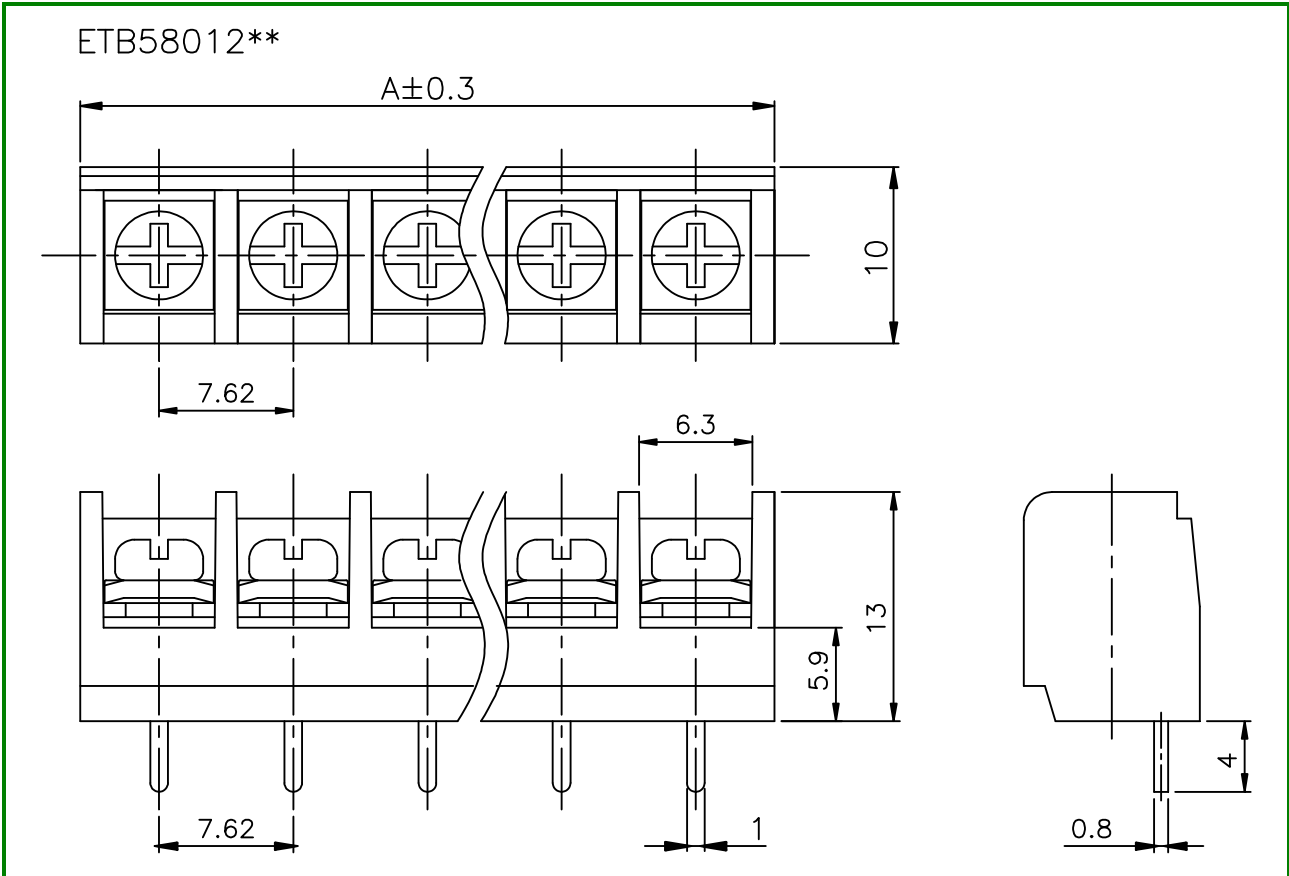

mm to inch

mm	0.8	1	1.32	4	5.9	7.62	10	13
inch	0.031	0.039	0.052	0.157	0.232	0.300	0.394	0.512

DIMENSIONS OF BARRIER TYPE

**NUMBER OF POLE 03~09.

POLE DIM.	3	4	5	6	7	8	9
$A \pm 0.3$	24.18 (0.952)	31.80 (1.252)	39.42 (1.552)	47.04 (1.852)	54.66 (2.152)	62.28 (2.452)	69.90 (2.752)