

# WIRE TO PCB TYPE TERMINAL BLOCK — ETB53 SERIES



**MOUNT TYPE / BARRIER TYPE**      **PITCH=10mm**

## ■ FEATURES

- Can be supplied in any number of positions
- Special wire protector design to ensure reliable wire clamping
- UL 94V-0 grade fire retardant engineering plastic used for the housing
- Be capable of clamping a wide range of wire diameters
- Wide choice of pitch & terminal

## ■ SPECIFICATIONS

- Pitch                                    10mm (0.394 inch)
- Wire range                            14~22 AWG
- Rating                                    20 Amp, 300 VAC
- Housing material                    Thermoplastic (UL 94V-0) Black
- Terminals                              Tin plated over Brass
- Screws                                  Nickel plated over Steel
- Dielectric strength                2000 VAC (Min.)
- Insulation resistance              1000 MΩ, 500 VDC



## ■ PART NUMBERING SYSTEM

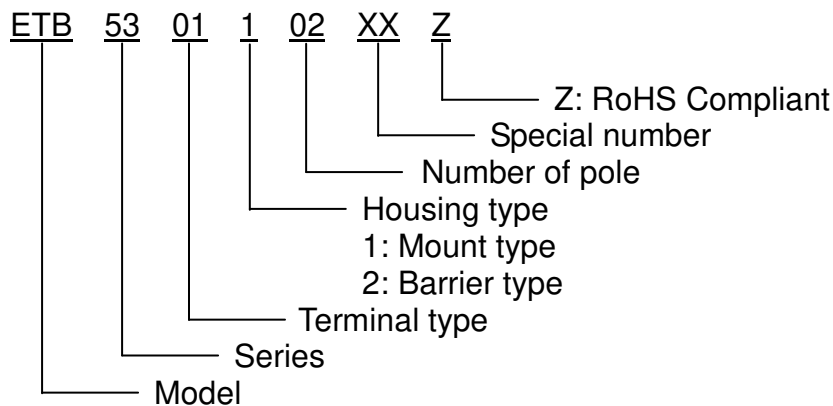

# WIRE TO PCB TYPE TERMINAL BLOCK - ETB53 SERIES



## ■ DRAWING (MOUNT TYPE)

ETB53001\*\*

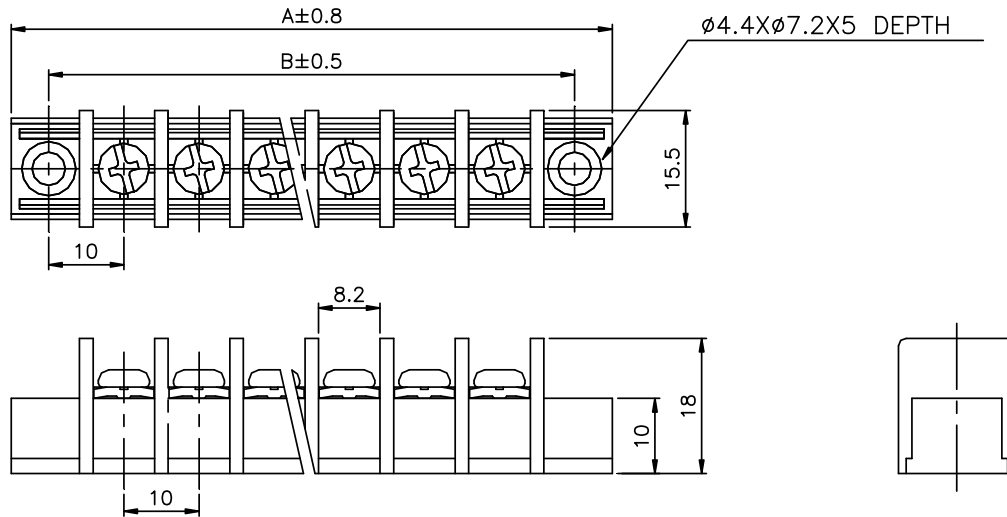

ETB53011\*\*

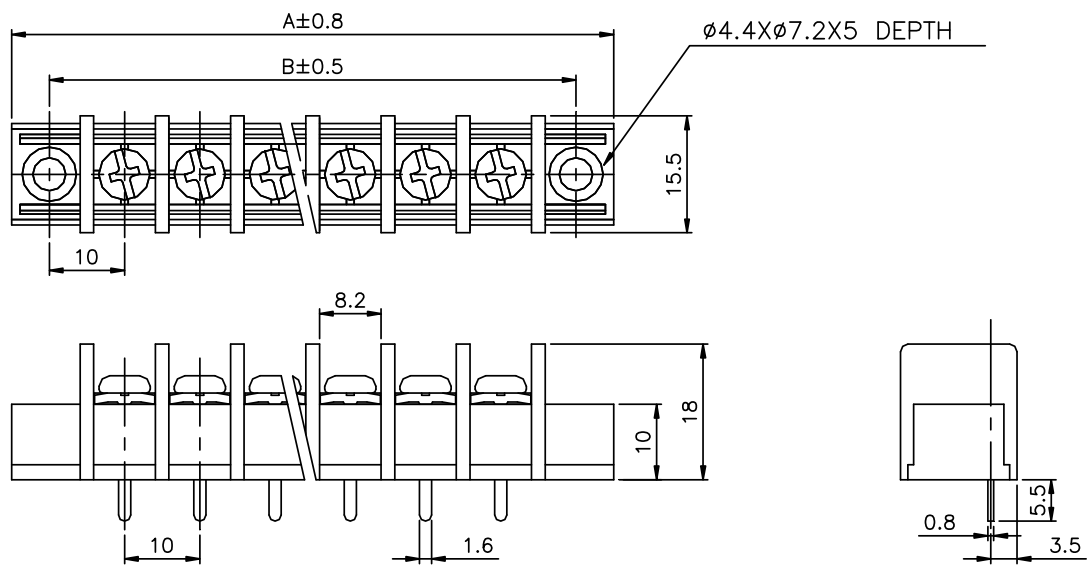

# WIRE TO PCB TYPE TERMINAL BLOCK — ETB53 SERIES



ETB53021\*\*

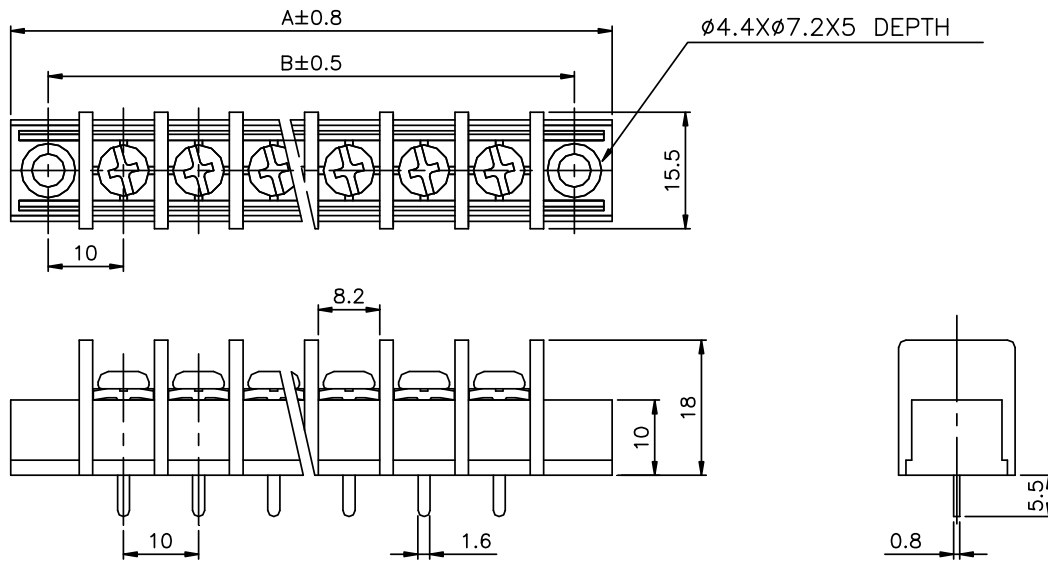

ETB53031\*\*

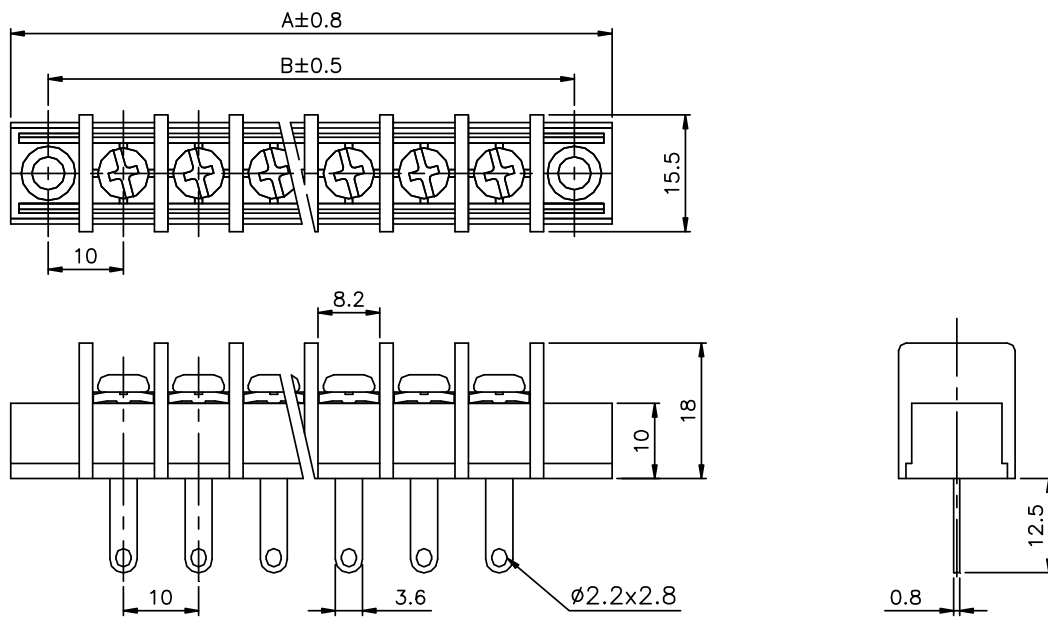

# WIRE TO PCB TYPE TERMINAL BLOCK - ETB53 SERIES



ETB53051\*\*

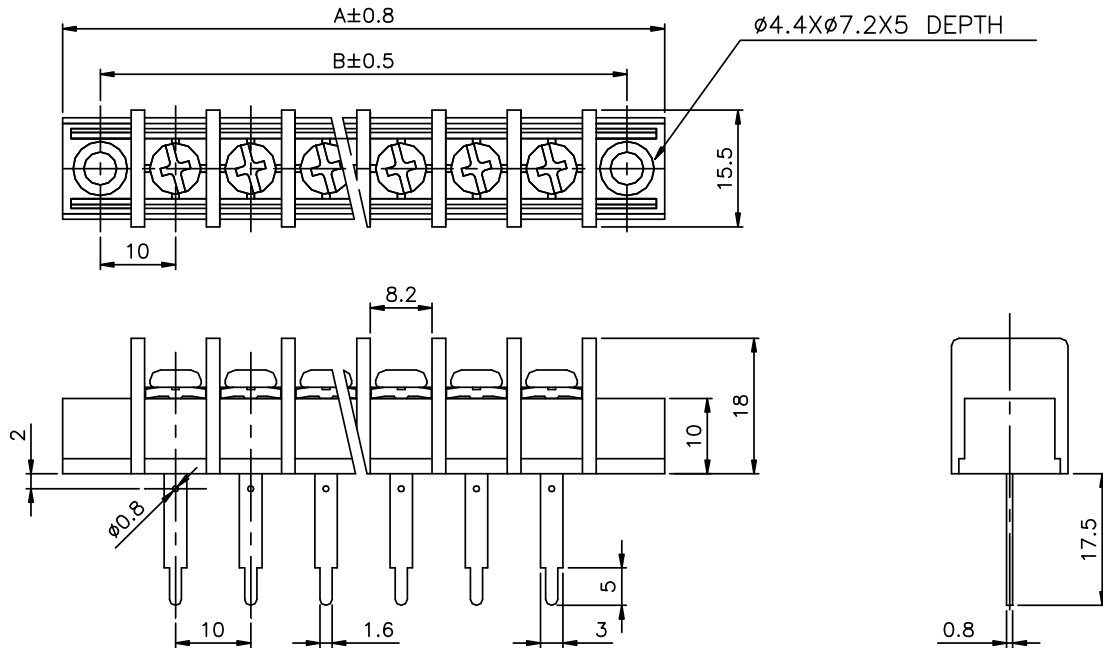

ETB53061\*\*

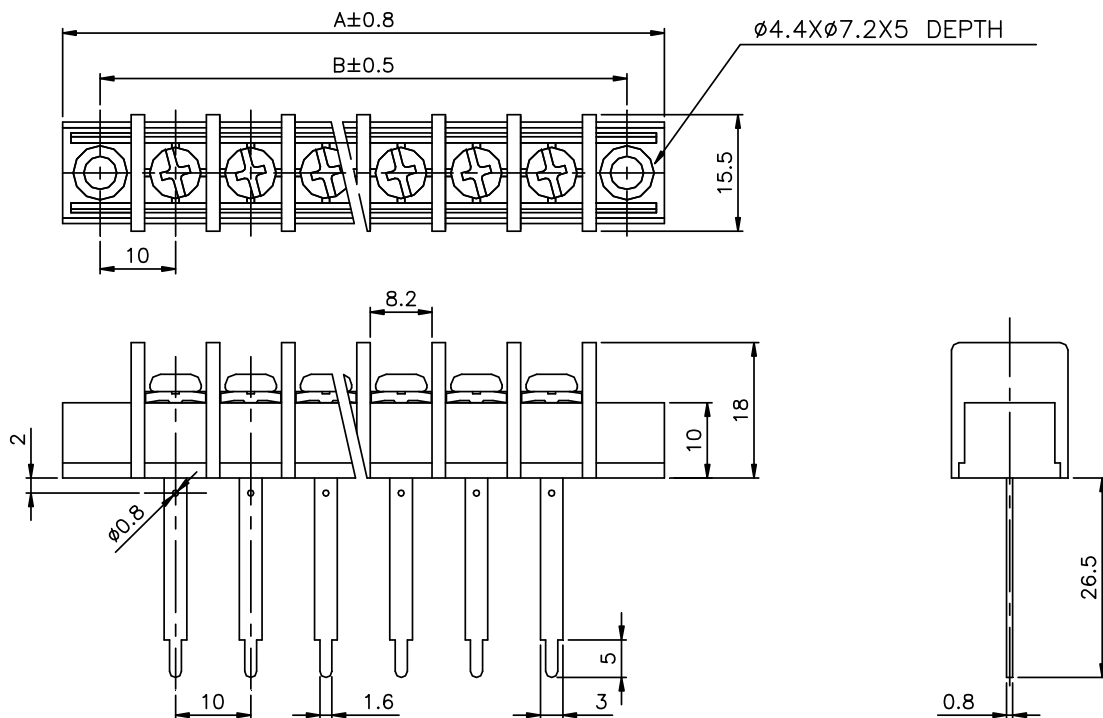

# WIRE TO PCB TYPE TERMINAL BLOCK — ETB53 SERIES



ETB53081\*\*

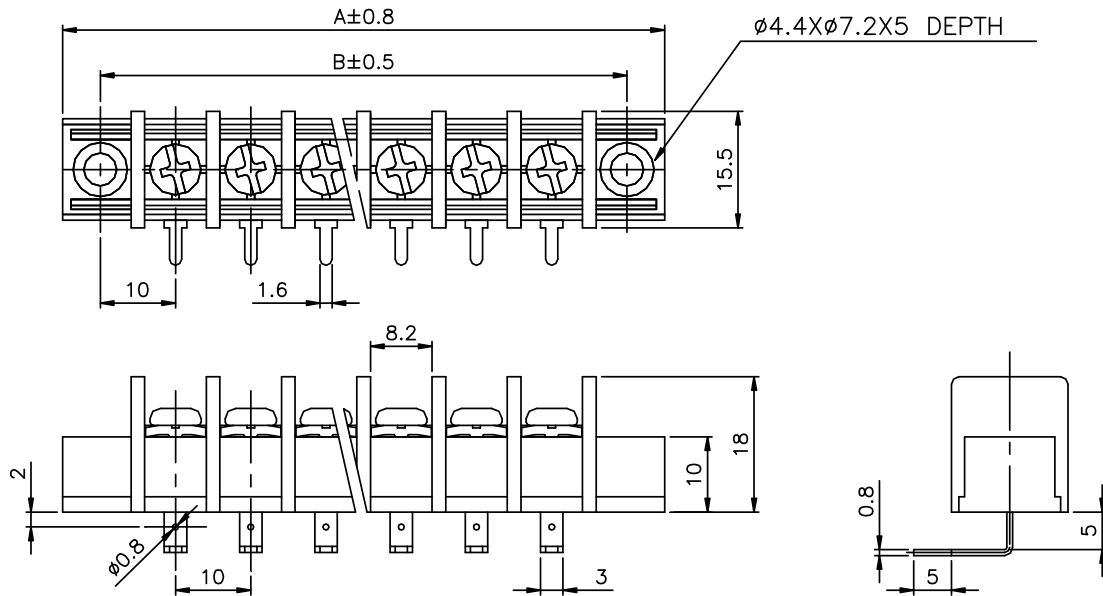

ETB53091\*\*

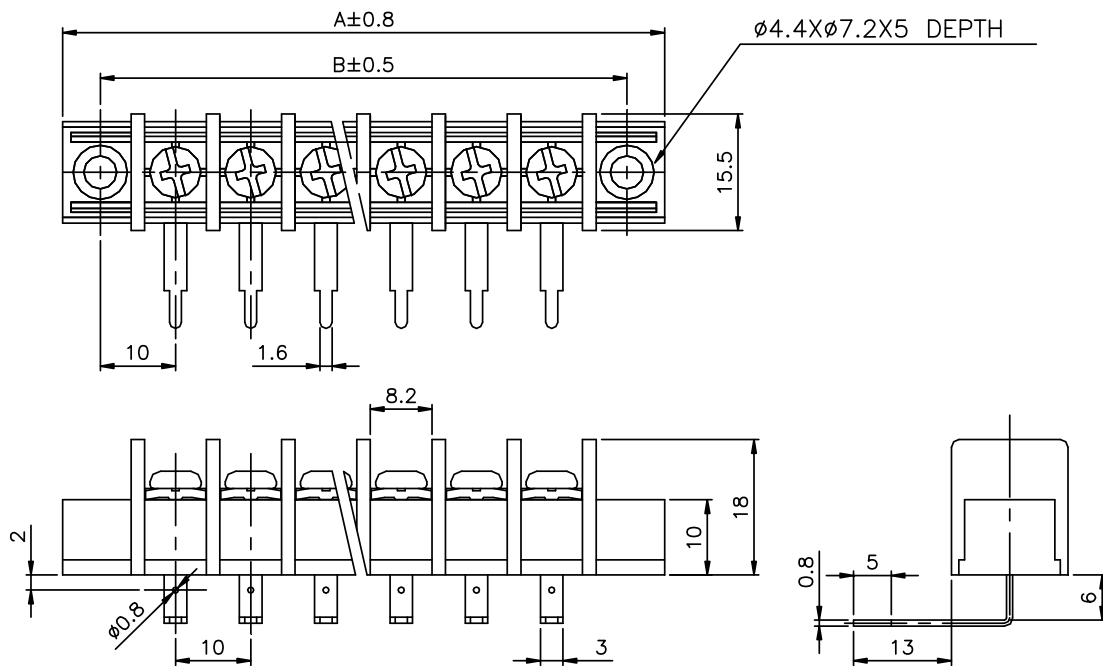

# WIRE TO PCB TYPE TERMINAL BLOCK - ETB53 SERIES



ETB53101\*\*

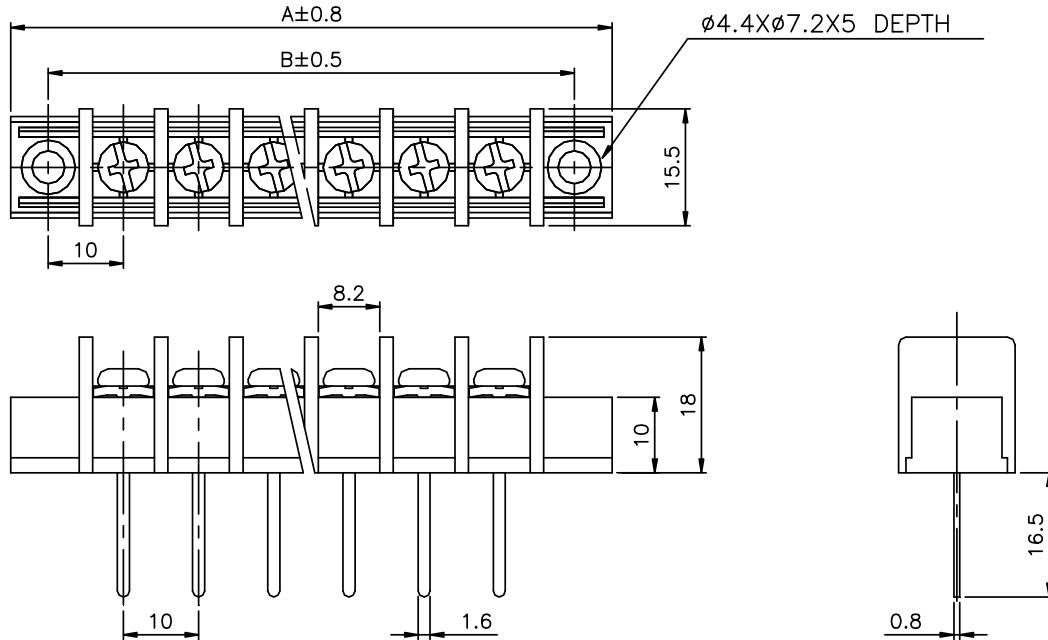

mm to inch

mm	0.8	1.6	2	2.8	3	3.5	3.6	4.4	5	5.5	6	7.2	8.2	10	12.5
inch	0.031	0.063	0.079	0.110	0.118	0.138	0.142	0.173	0.197	0.217	0.236	0.283	0.323	0.394	0.492
mm	13	15.5	16.5	17.5	18	26.5									
inch	0.512	0.610	0.650	0.689	0.709	1.043									

DIMENSIONS OF MOUNT TYPE

\*\*NUMBER OF POLE 02~30.

POLE DIM.	2	3	4	5	6	7	8	9	10	11	12
A $\pm 0.8$	40 (1.575)	50 (1.969)	60 (2.362)	70 (2.756)	80 (3.150)	90 (3.543)	100 (3.937)	110 (4.331)	120 (4.724)	130 (5.118)	140 (5.512)
B $\pm 0.5$	30 (1.181)	40 (1.575)	50 (1.969)	60 (2.362)	70 (2.756)	80 (3.150)	90 (3.543)	100 (3.937)	110 (4.331)	120 (4.724)	130 (5.118)
POLE DIM.	13	14	15	16	17	18	19	20	21	22	23
A $\pm 0.8$	150 (5.906)	160 (6.299)	170 (6.693)	180 (7.087)	190 (7.480)	200 (7.874)	210 (8.268)	220 (8.661)	230 (9.055)	240 (9.449)	250 (9.843)
B $\pm 0.5$	140 (5.512)	150 (5.906)	160 (6.299)	170 (6.693)	180 (7.087)	190 (7.480)	200 (7.874)	210 (8.268)	220 (8.661)	230 (9.055)	240 (9.449)
POLE DIM.	24	25	26	27	28	29	30				
A $\pm 0.8$	260 (10.236)	270 (10.630)	280 (11.024)	290 (11.417)	300 (11.811)	310 (12.205)	320 (12.598)				
B $\pm 0.5$	250 (9.843)	260 (10.236)	270 (10.630)	280 (11.024)	290 (11.417)	300 (11.811)	310 (12.205)				



An ISO 9001 Company

# WIRE TO PCB TYPE TERMINAL BLOCK — ETB53 SERIES



## DIMENSIONS OF BARRIER TYPE

\*\*NUMBER OF POLE 02~32.

POLE DIM. \	2	3	4	5	6	7	8	9	10	11	12
A±0.8	22 (0.866)	32 (1.260)	42 (1.654)	52 (2.047)	62 (2.441)	72 (2.835)	82 (3.228)	92 (3.622)	102 (4.016)	112 (4.409)	122 (4.803)
B±0.5	10 (0.394)	20 (0.787)	30 (1.181)	40 (1.575)	50 (1.969)	60 (2.362)	70 (2.756)	80 (3.150)	90 (3.543)	100 (3.937)	110 (4.331)
POLE DIM. \	13	14	15	16	17	18	19	20	21	22	23
A±0.8	132 (5.197)	142 (5.591)	152 (5.984)	162 (6.378)	172 (6.772)	182 (7.165)	192 (7.559)	202 (7.953)	212 (8.346)	222 (8.740)	232 (9.134)
B±0.5	120 (4.724)	130 (5.118)	140 (5.512)	150 (5.906)	160 (6.299)	170 (6.693)	180 (7.087)	190 (7.480)	200 (7.874)	210 (8.268)	220 (8.661)
POLE DIM. \	24	25	26	27	28	29	30	31	32		
A±0.8	242 (9.528)	252 (9.921)	262 (10.315)	272 (10.709)	282 (11.102)	292 (11.496)	302 (11.890)	312 (12.283)	322 (12.677)		
B±0.5	230 (9.055)	240 (9.449)	250 (9.843)	260 (10.236)	270 (10.630)	280 (11.024)	290 (11.417)	300 (11.811)	310 (12.205)		