

**SPECIFICATIONS**

**RATING** : Ith 5A/ 250VAC resistive load 3A/250VAC.  
**CONTACT RESISTANCE** : 50mΩmax. @ 1A 12VDC (initial value).  
**INSULATION RESISTANCE** : 1, 000 MΩ min. at 500VDC.  
**DIELECTRIC STRENGTH** : 2, 000V RMS @ sea level.  
**OPERATION TEMPERATURE** : -20°C to 55°C.  
**MECHANICAL LIFE** : Momentary 1, 000, 000 cycles / Self-lock 500, 000 cycles.  
**ELECTRICAL LIFE** : 50, 000 make-and-break cycles at full load.  
**TORQUE** : 5~14Nm.  
**OPERATION PRESSURE** : 1Pole 2.5± 1N / 2Poles 3.5± 1N.  
**TRAVEL** : About 3.2mm.  
**INGRESS PROTECTION** : IP67, IK10(Stainless).

**RA** models available,  
consult sales representatives.

**MATERIALS**

**BUSHING**: Stainless Steel / Aluminum alloy.  
**BASE**: PBT (UL 94-V0), PC( UL 94-V2).  
**ACTUATOR**: PC; Stainless Steel / Aluminum alloy.  
**INNER ASSEMBLY** : POM / PA66.  
**SPRING**: Spring steel.  
**SEALING**: Silicone.  
**O-Ring**: Silicone.  
**TERMINAL**: Brass , with silver or gold plated.  
**CONTACT**: Brass, coin silver, with silver or gold plated.  
**HEX NUT**: Nickel plated brass.

**PART NUMBERING SYSTEM**

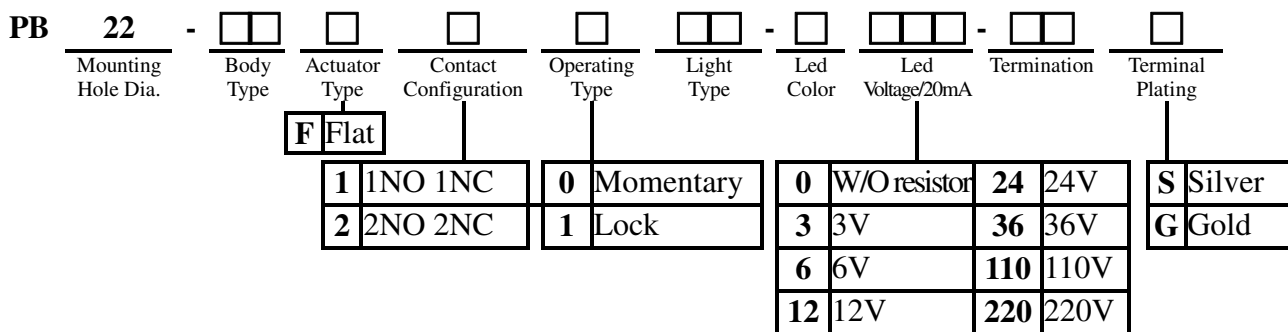

**Body type**

Unit: Inch/mm

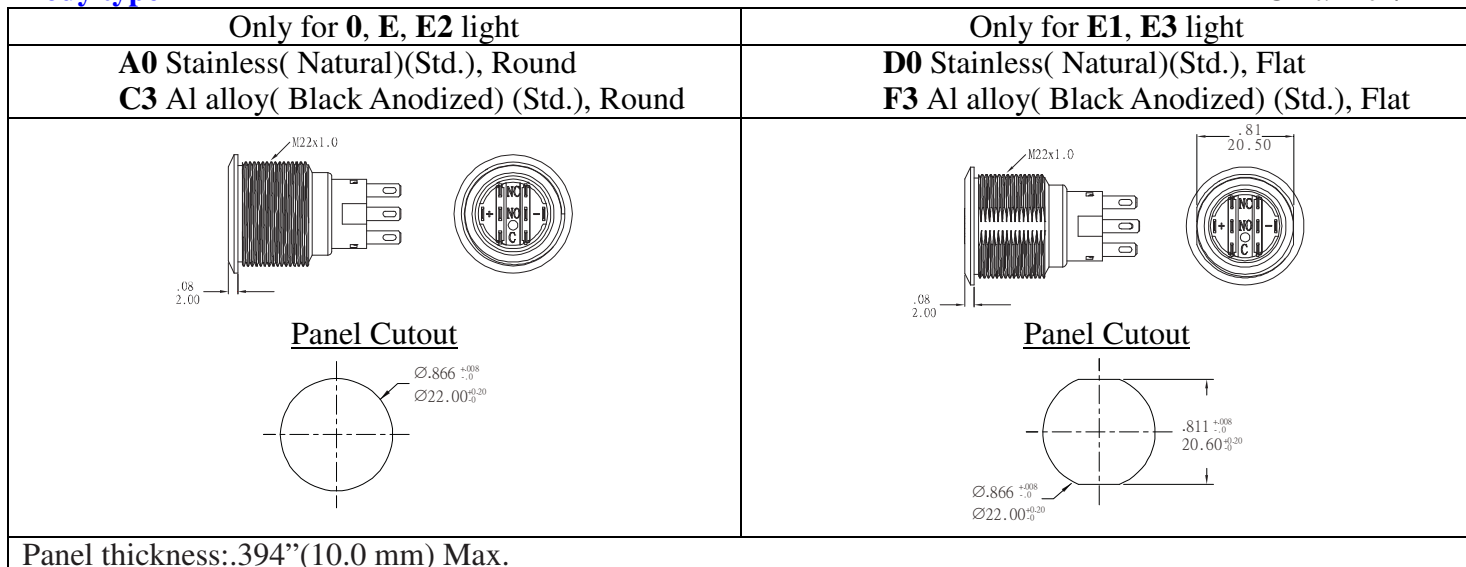

Specifications and dimensions are subject to change.

# Ø22mm Metal Pushbutton Switches – PB22 series

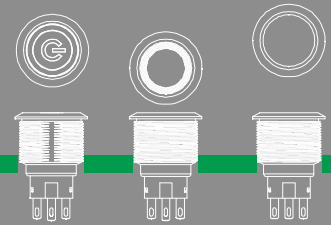

## Light type

Unit: Inch/mm

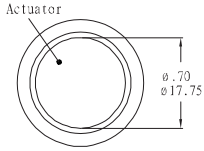
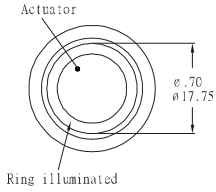
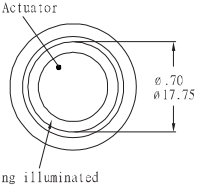
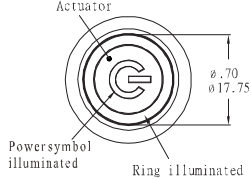
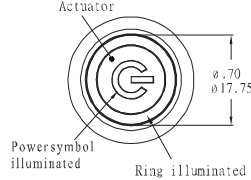
0 Without Led	E Ring( Moveable)	E2 Illuminated ring
 <p>Actuator</p> <p>Only for <b>A0, D0</b> body Only stainless steel body</p>	 <p>Actuator</p> <p>Ring illuminated</p> <p>Only for <b>A0, C3, D0, F3</b> body</p>	 <p>Actuator</p> <p>Ring illuminated</p> <p>Only for <b>A0</b> body Available only with red, green, blue led color.</p>
E1 Illuminated ring with power symbol		E3 Illuminated ring with power symbol
 <p>Actuator</p> <p>Powersymbol illuminated</p> <p>Ring illuminated</p> <p>For body type <b>D0</b> only Available only with white( Natural) lens only.</p>		 <p>Actuator</p> <p>Powersymbol illuminated</p> <p>Ring illuminated</p> <p>For body type <b>D0</b> only Available only with red, green, blue led color.</p>

## Dimensions

Unit: Inch/mm

Part No. Shown: PB22-A0F1□0-M1S

0 Without Led

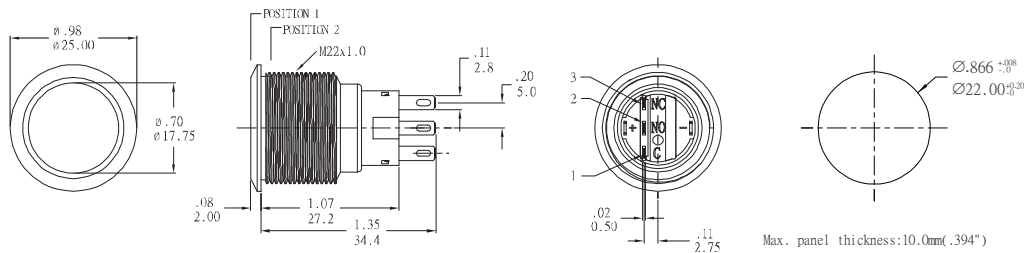

Part No. Shown: PB22-A0F2□E-□□-M1S

E Ring( Moveable)

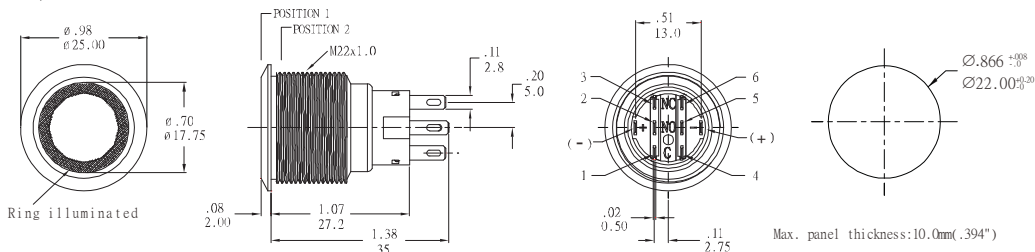

Part No. Shown: PB22-D0F2□E3-□□-M1S

E3 Ring + Power symbol

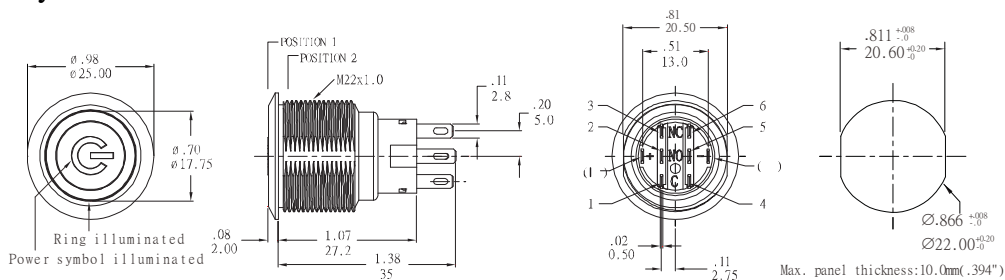

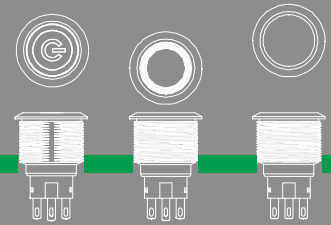

**Led Color**

Single color Led			
<b>0</b>	Without Led	<b>5</b>	Yellow
<b>1</b>	White	<b>6</b>	Green
<b>3</b>	Red	<b>7</b>	Blue

Dual color Led					
<b>A</b>	Red + Green	<b>G</b>	Red + Yellow	<b>P</b>	Blue + Green
<b>B</b>	Red + Blue	<b>H</b>	Green + Yellow		
<b>D</b>	Blue + Yellow	<b>J</b>	Orange + Green		

**Circuit**

Without Led Single pole	Single color Led Single pole	Dual color Led Single pole
Double pole	Double pole	Double pole

**Termination**

Unit: Inch/mm

M1 Solder terminal( STD.)	S1 Short solder terminal

**T** Wire leads UL3385 18AWG ( Flying lead terminal)

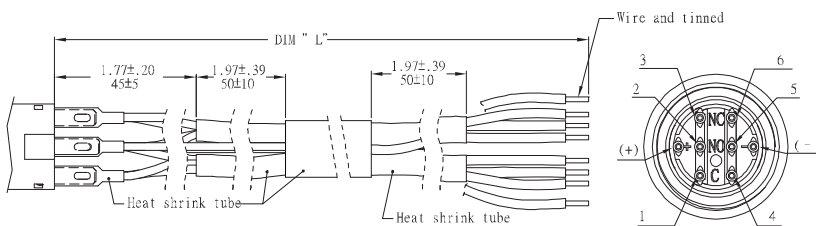

<b>T1</b>	Flying lead terminals L=500mm
<b>T2</b>	Flying lead terminals L=1000mm
<b>T3</b>	Flying lead terminals L=1500mm
<b>T4</b>	Flying lead terminals L=2000mm

**D1 Molding, 500mm wire leads UL3385 18 AWG**

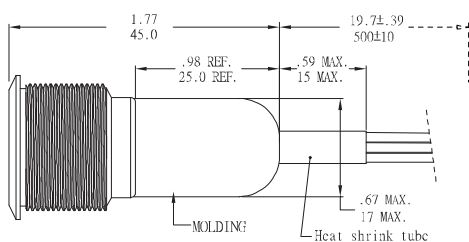

Wires:  
 Yellow wire - Terminal 1 and 4  
 Purple wire - Terminal 2 and 5  
 Green wire - Terminal 3 and 6  
 Red wire - LED (+) Positive  
 Black wire - LED (-) Negative

\*Please consult sales for additional wire options.

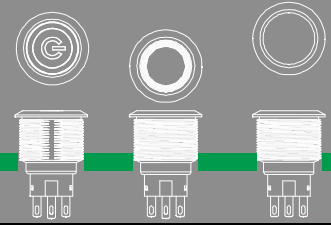

**Assembled view**

Unit: Inch/mm

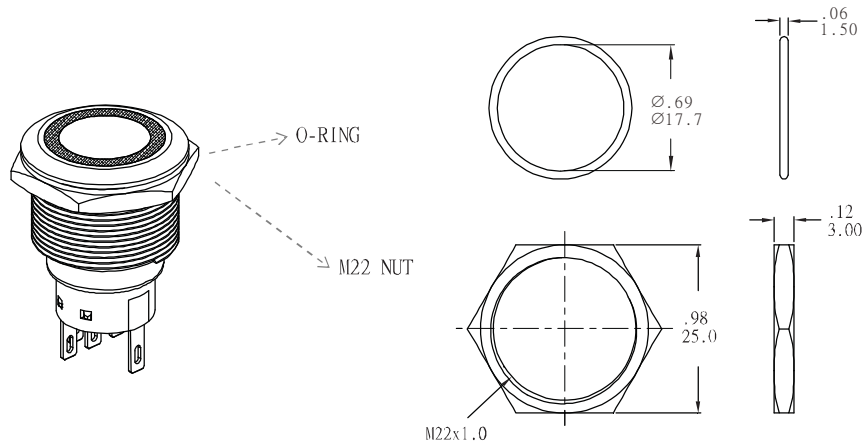

**O-RING INSTALLATION**

Proposal	In front of the panel	Behind the panel
Installation Diagram	<p>O-RING</p>	<p>O-RING</p>