

SPECIFICATIONS

RATING : Max. 2A/36VDC; Min. 0.5A/12VDC

ELECTRICAL LIFE : 200,000 make-and-break cycles at full load

MECHANICAL LIFE : 1,000,000 cycles

INSULATION RESISTANCE : 1,000 MΩ min. at 500VDC

DIELECTRIC STRENGTH : 2,000V RMS @ sea level

CONTACT RESISTANCE : 50 mΩ max.

OPERATION TEMPERATURE : -20°C~+70°C

TRAVEL: About 2.0±0.20mm

OPERATION PRESSURE : 4.5N±1.5N

INGRESS PROTECTION : IP67(In house test)

TORQUE : 11.5 kgf · cm

MATERIALS

BUSHING: Aluminum alloy / Stainless Steel.

BASE: PBT (UL 94-V0).

ACTUATOR: PC (Translucent UL 94-V2).

CAP: Aluminum alloy / Stainless Steel.

SPRING: Steel.

SEALING: Silicone (Translucent).

O-Ring: Silicone (Translucent).

TERMINAL: Brass , Gold flash plated.

CONTACT: Silver alloy.

HEX NUT: Brass (Nickel plated).

PART NUMBERING SYSTEM

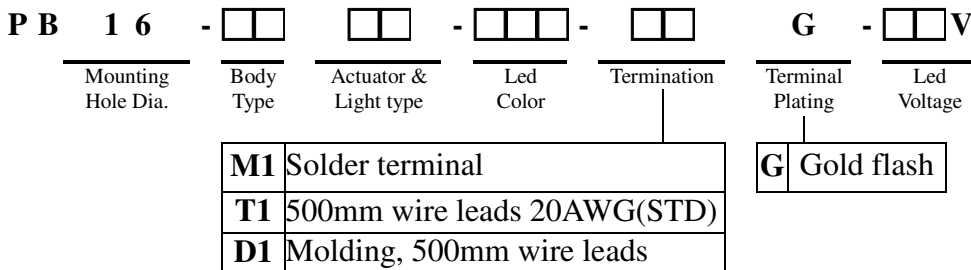

Body type

Unit: Inch/mm

CA Aluminum Alloy, Natural anodized	CB Aluminum Alloy, Black anodized	A1 Stainless, Natural Two side flat	A2 Stainless, Natural Round	A3 Stainless, Natural, D shape
<p>Panel Cutout</p>	<p>Panel Cutout</p>	<p>Panel Cutout</p>	<p>Panel Cutout</p>	<p>Panel Cutout</p>

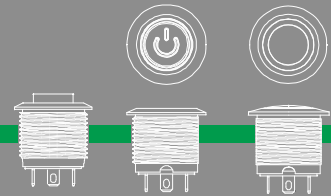

Actuator & Light type

Unit: Inch/mm

For Body type CA, CB only	For Body type A1, A2, A3 only	
<p>RE Round top, Ring light</p>	<p>HE Flat top, Extended actuator, Ring light</p>	<p>FE Flat actuator, Ring light</p>
<p>RP Round top, Power symbol</p>	<p>HN Flat top, Extended actuator, W/O Led</p> <p>Only for high actuator</p>	<p>FP Flat actuator, Power symbol</p>

Dimensions

Unit: Inch/mm

Part No. Shown: PB16-CARE-□-M1G-0V

RE Round actuator, Ring light

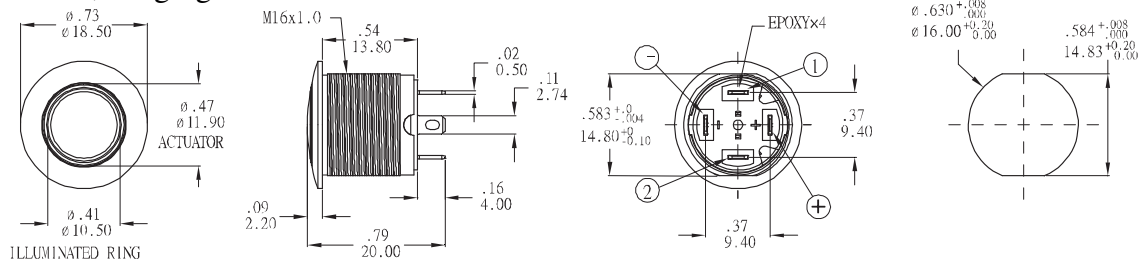

Part No. Shown: PB16-CBRP-□-M1G-0V

RP Round actuator, Power symbol

Black anodized actuator, Black anodized body

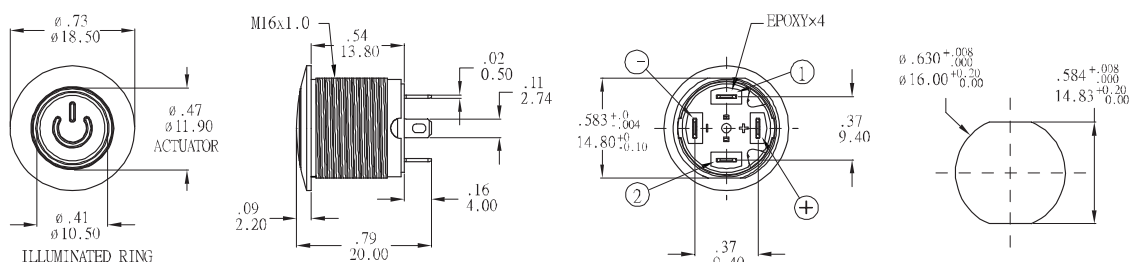

Part No. Shown: PB16-A2HE-□-M1G-0V

HE Flat top, Extended actuator, Ring light

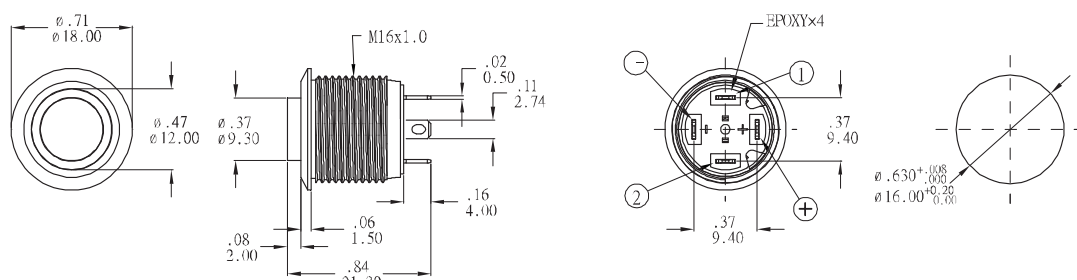

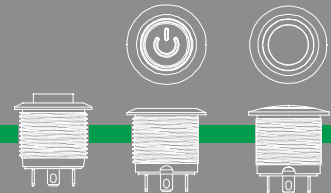

Dimensions

Unit: Inch/mm

Part No. Shown: PB16-A3FP-□-M1G-0V

FP Flat actuator, Power symbol

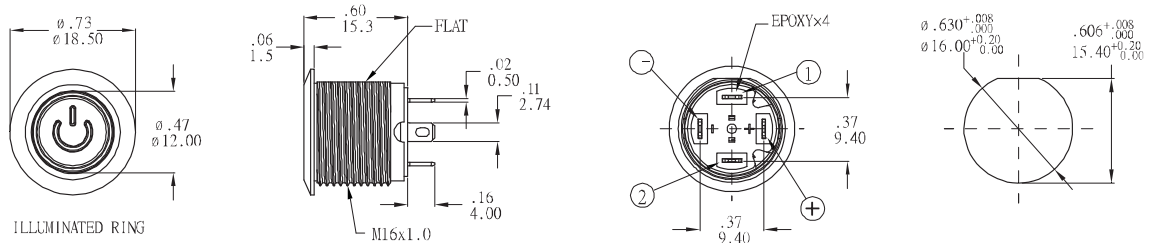

Part No. Shown: PB16-CARP-RGB-M1G-0V

RP Round actuator, Power symbol

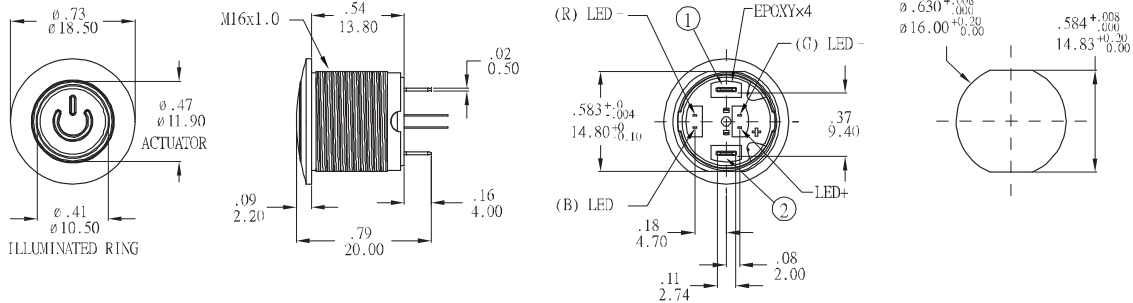

Led Color

*Current limiting resistor is required to limit LED forward current to 20mA

Single color Led			
0	Without Led	5	Yellow
1	White	6	Green
3	Red	7	Blue
4	Orange		

Dual color Led	
A	Red & Green

RGB color Led	
RGB	Red/Green/ Blue

Circuit

*According to the input voltage adjustment resistance.

Without Led	Single color Led	Dual color Led	RGB color Led	
			For 6V/ 12V/ 24V	For 3V

Panel cutout

Panel thickness: 8.0mm(.031") Max.

Hardware

Unit: Inch/mm

For CA/CB/A1 type	For A2 type	For A3 type	O-ring	M16 Nut

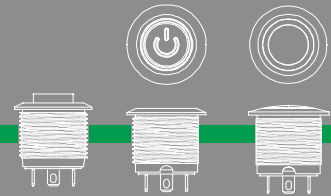

Unit: Inch/mm

Termination

M1 Solder

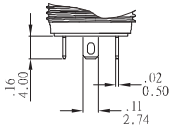

T1 500mm wire leads 20AWG

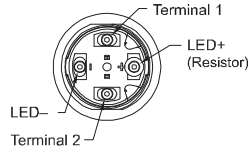
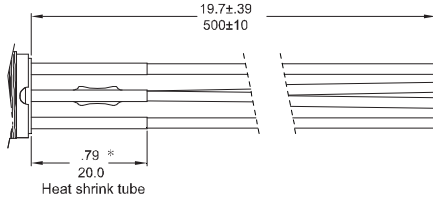

Wires:

- Black wire – Terminal
- Red wire – LED(+) Positive
- Green wire – LED(-) Negative
- *No illumination: Black wire – Terminal

*No external resistance heat shrink sleeve .394”(10mm)

T1 500mm wire leads 20AWG(RGB LED)

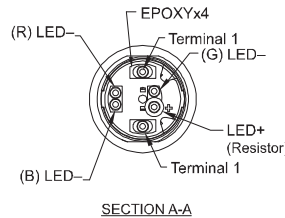
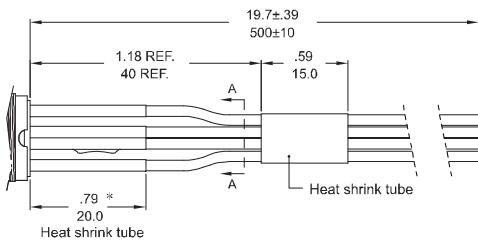

Wires:

- Black wire – Terminal
- White wire – LED(+) Positive
- Red wire – (R)LED(-) Negative
- Blue wire – (G)LED(-) Negative
- Green wire – (B)LED(-) Negative

*No external resistance heat shrink sleeve .394”(10mm)

D1 Molding, 500mm wire leads

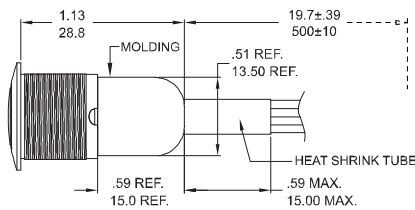

Wires: 20 AWG

- Black wire – Terminal
- Red wire – LED(+) Positive
- Green wire – LED(-) Negative
- *No illumination: Black wire - Terminal

RGB LED Wires: 22 AWG

- Black wire – Terminal
- White wire – LED(+) Positive
- Red wire – (R)LED(-) Negative
- Blue wire – (G)LED(-) Negative
- Green wire – (B)LED(-) Negative

Led Voltage

Resistance (About Led voltage)

0V	Without resistance
3V	Led input 3 VDC, 47Ω *Red/ Yellow/ Orange Led type only
6V	Led input 6 VDC, 180Ω
12V	Led input 12 VDC, 470Ω
24V	Led input 24 VDC, 1000Ω

*ohms value of resistance tolerance: ± 5%

Specifications and dimensions are subject to change.

For the latest product information, please visit our website at www.pacer.com.tw or email us at pacer@mail.ece.com.tw